

Comfort series
5 mm embeddable

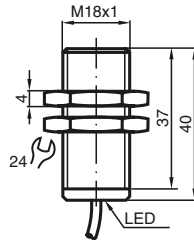

General specifications	
Switching element function	DC Make function
Rated operating distance s_n	5 mm
Installation	embeddable
Assured operating distance s_a	0 ... 4.05 mm
Reduction factor r_{Al}	0.37
Reduction factor r_{Cu}	0.33
Reduction factor r_{V2A}	0.7
Nominal ratings	
Operating voltage U_B	5 ... 60 V
Switching frequency f	0 ... 350 Hz
Hysteresis H	1 ... 10 typ. 5 %
Reverse polarity protection	tolerant
Short-circuit protection	pulsing
Voltage drop U_d	≤ 5 V
Operating current I_L	2 ... 100 mA
Off-state current I_r	0 ... 0.5 mA typ.
Indication of the switching state	all direction LED, yellow
Standard conformity	
Standards	EN 60947-5-2:2004
Ambient conditions	
Ambient temperature	-25 ... 70 °C (248 ... 343 K)
Mechanical specifications	
Connection type	2 m, PUR cable
Cable version	PA
Core cross-section	0.34 mm ²
Housing material	Stainless steel
Sensing face	PBT
Protection degree	IP67

Connection type:

Z0

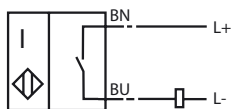

Comfort series
5 mm embeddable

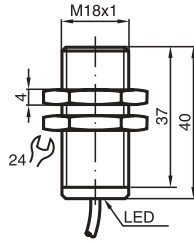

Switching element function	DC	Break function
Rated operating distance s_n	5 mm	
Installation	embeddable	
Assured operating distance s_a	0 ... 4,05 mm	
Reduction factor r_{Al}	0,37	
Reduction factor r_{Cu}	0,33	
Reduction factor r_{V2A}	0,7	
Operating voltage U_B	5 ... 60 V	
Switching frequency f	0 ... 350 Hz	
Hysteresis H	1 ... 10 typ. 5 %	
Reverse polarity protection	tolerant	
Short circuit protection	pulsing	
Voltage drop U_d	Ω 5 V	
Operating current I_L	2 ... 100 mA	
Off-state current I_r	0 ... 0,5 mA typ.	
Indication of the switching state	all direction LED, yellow	
Standards	EN 60947-5-2	
Ambient temperature	-25 ... 70 °C (248 ... 343 K)	
Connection type	2 m, PUR cable	
Cable version	PA	
Core cross-section	0.34 mm ²	
Housing material	high grade steel	
Sensing face	PBT	
Protection degree	IP67	

Connection_type:

Z1

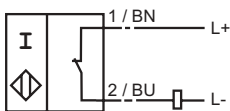

089262_ENG.xml

2003-07-08